



The 15 metre deep cutting will become 35m deep



Two tunnel boring machines will arrive at the new portal south of Parkway



The 15 metre high retaining wall that will be demolished and rebuilt as 35 metres deep

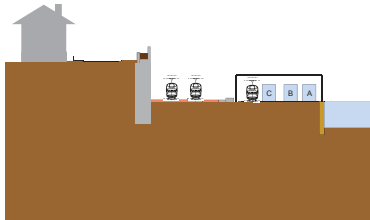

Existing cross section at Park Village East with 15 metre deep cutting

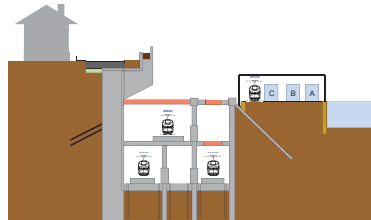

New cross section at Park Village East with HS2 in 35 metre deep cutting



Machinery that will be used on our streets to construct the new deeper cutting

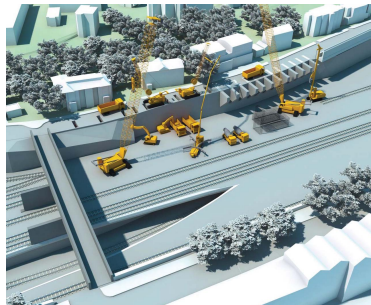

View of HS2 works to Park Village East retaining wall

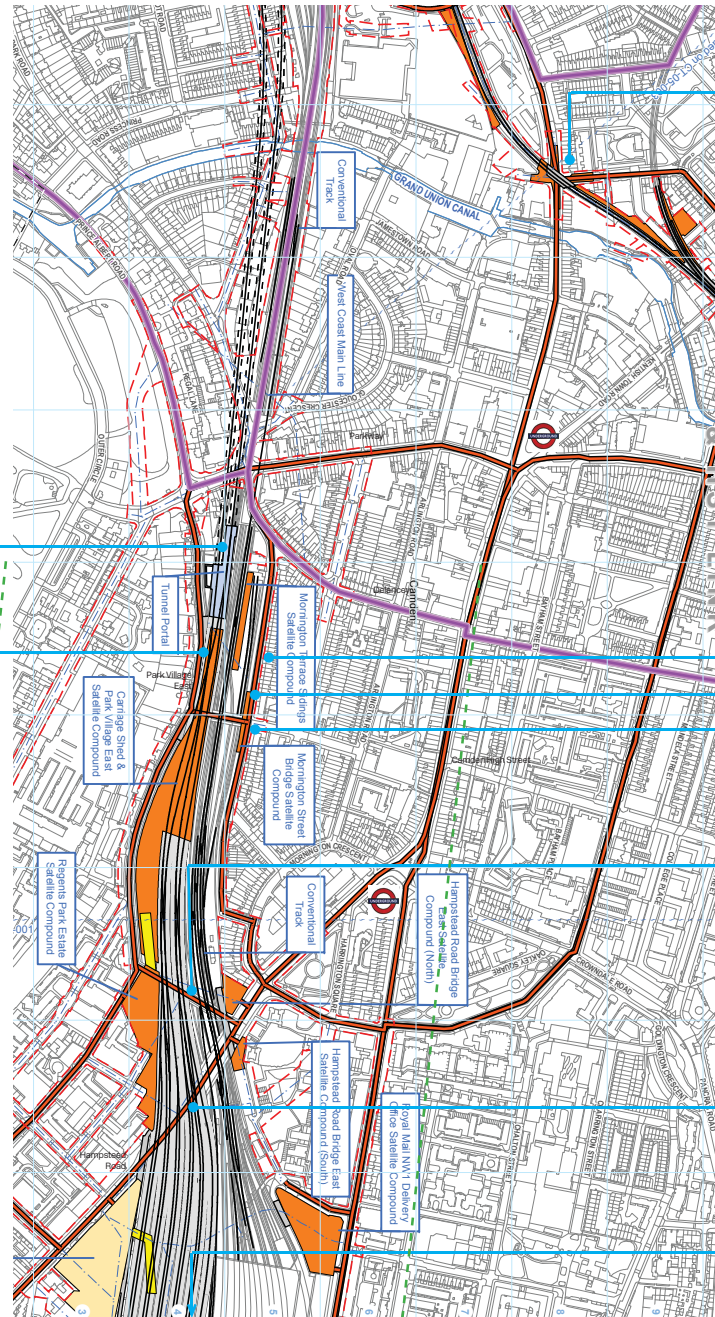

Plan of HS2 north of Euston Station

← Approximate line of 200 metre land charge boundary



Nine North London Line bridges to be demolished & rebuilt



Heavy lorries on neighbourhood streets (in orange) for ten years



Seven works compounds near Camden Cutting



Mornington Street bridge to be demolished and rebuilt



Granby Terrace bridge to be demolished and rebuilt



Hampstead Road bridge to be demolished and rebuilt **four metres higher**

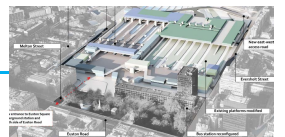

New HS2 station at Euston

# Ten Years of HS2 Construction in Camden 2016 - 2025

Produced by the Camden Cutting Group using the HS2 Draft Environmental Statement and other information from HS2. What actually happens could be different.